

YCM8-□HU series

Photovoltaic AC MCCB

OPERATION INSTRUCTION

Standard:IEC/EN60947-2

CNC Deliver
Power For Better Life

 Before installing and using this product, please read this manual carefully and pay more attention to safety.

1. Product description

YCM8-HU series AC molded case circuit breaker is suitable for AC grid circuits with rated voltage up to AC1140V and rated current of 800A.

The circuit breaker has the functions of overload long-time delay protection and short-circuit instantaneous protection, and is used to distribute electric energy and protect lines and power supply equipment from overload, short circuit and other faults.

2. Type and meaning

YCM8 - 250 S HU / 3 125A

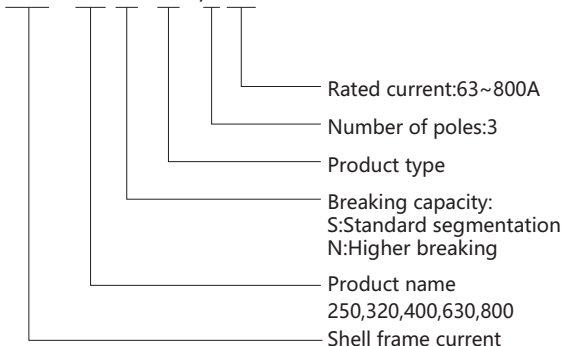

3. Technical data

Model	YCM8- 250HU			YCM8- 320HU			YCM8- 400HU			YCM8-630HU			YCM8-800HU				
Shell frame current I _{rn} (A)	250			320			400			630			800				
Number of poles of products	3			3			3			3			3				
AC working voltage(V)	415	690	800	1140	415	690	800	1140	415	690	800	1140	415	690	800	1140	
Rated insulation voltage(U _i (V))	AC1150			AC1150			AC1150			AC1150			AC1150				
Rated impulse withstand voltage U _{imp} (kV)	8			8			12			12			12				
Rated current I _n (A)	63, 80, 100, 125, 140, 160, 180, 200, 225, 250			280, 315, 320			225, 250, 315, 350, 400			500, 630			700, 800				
Ultimate short-circuit breaking capacity I _{cu} (kA)	S	85	50	36.5	10	85	50	36.5	10	85	50	36.5	10	85	50	36.5	10
Running short-circuit breaking capacity I _{cs} (kA)	N	/	/	/	/	100	60	50	15	100	60	50	15	100	60	50	15
Wiring method	I _{cs} =100%I _{cu}																
Isolation function	Up in and down out, down in and up out, Down in and up out, up in and down out(3P)																
Tripping type	Yes																
Electrical life(time)	3000 3000 2000			3000 3000 2000			1000 1000 700			1000 1000 700			1000 1000 700				
Mechanical life(time)	20000			20000			10000			5000			5000				
Standard	IEC/EN60947-2																
Attached accessories	Shunt,Alarm,Auxiliary,Manual operation, Electric operation																
Certifications	CE																
Overall dimension	Width(W)			107			107			182			182				
	Height(H)			180			180			250			250				
	Depth(D)			126			126			165			165				

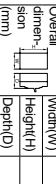

Note: ① 2P connection in series, ② 3P connection in series

4. Usage Information

- ① The normal operating environment temperature of the product is $-5^{\circ}\text{C}\sim+40^{\circ}\text{C}$;
Note: If used within the range of -35°C to $+70^{\circ}\text{C}$, please consult
- ② with the manufacturer for use When the altitude exceeds 4000m, please consult with the manufacturer for use;
- ③ Pollution level: Level 3;
- ④ Main circuit installation category: III;
- ⑤ Shell protection level: IP20;

5. Inspection and testing

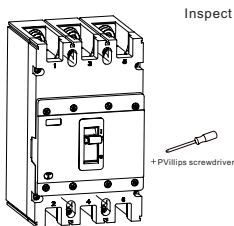

Model	Recommended installation screws	Quantity
YCM8-250/320HU	M4 × 90	4
YCM8-400/630/800HU	M5 × 85	2



1. Determine product technical parameters;
2. The installation, operation, and maintenance work of the product is limited to Limited to professionally qualified personnel.

Minimum installation distance

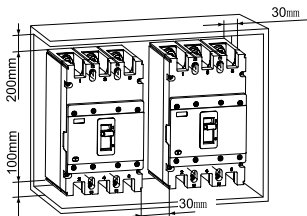

Ensure minimum installation distance

Pre-test

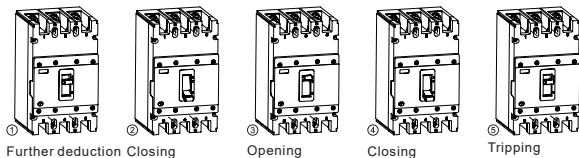

6. Appearance and installation dimensions

YCM8-250HU, 320HU

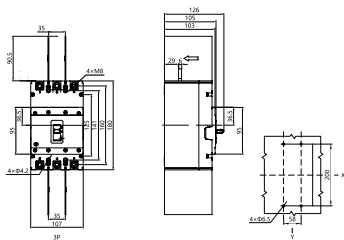

YCM8-400HU, 630HU, 800HU

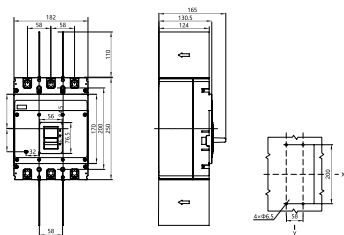

Installation drawing of YCM8-HU with arcing cover

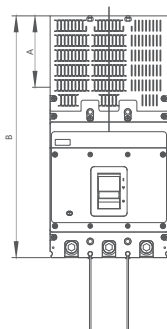

Circuit breaker	Arcing cover length A	Total length B
YCM8-250/320HU	64	245
YCM8-400/630/800HU	64	314

7.Attachment Information

Auxiliary contact wiring diagram

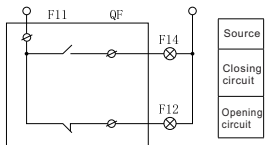

Wiring diagram of release

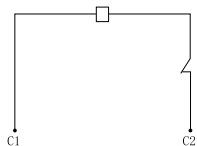

Installation of interPVase arc separation plate

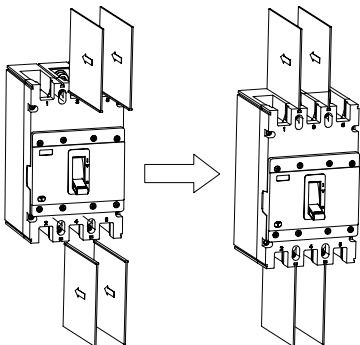

1. Be sure to install it before running the product Protective cover
2. Check if the product wiring is correct
3. Insulation resistance to ground after installation The inspection should not be less than 10M Ω

Installation of partitions and shields

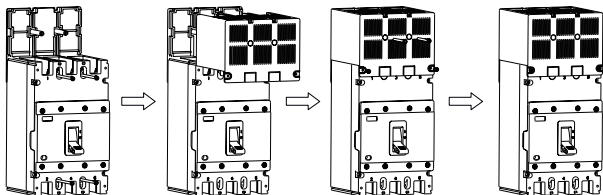

8. Warranty period

Under normal storage and transportation conditions, and with the product packaging or product itself intact, the product has a warranty period of 24 months from the date of production. The following situations are not covered by the warranty:

- ① Damage caused by improper use, storage, and maintenance by users.
- ② Damage caused by non company designated institutions or personnel, or self disassembly and repair.
- ③ The product has exceeded the warranty period.
- ④ Damage caused by force majeure factors.

9. Environmental protection

In order to protect the environment, when this product or its components are scrapped, please dispose of them properly as industrial waste; Or it can be handed over to a recycling station for classification, disassembly, recycling, and reuse in accordance with relevant national regulations.

Safety tips

- (1) The product is strictly prohibited from being installed in environments containing flammable and explosive gases or damp condensation, and it is strictly prohibited to operate the product with wet hands;
- (2) During product operation, it is strictly prohibited to touch conductive parts of the product
- (3) When installing, maintaining, and maintaining products, it is necessary to ensure that the circuit is powered off; (4) Do not install in areas where gas media can corrode metals and damage insulation;
- (5) To avoid dangerous accidents, the installation and fixation of the product must strictly follow the requirements of the manual.



CERTIFICATE

Product Model: YCM8- HU series

Inspector: **CNC001**

Standard: IEC/EN60947-2

Production date: Printed on the product
or package.

This product is qualified according
to the delivery inspection

A vertical red bar containing the white text 'CNC'.

YCM8-□ PV series

CNC ELECTRIC

Tel: 0086-577-61989999 Fax: 0086-577-61891122

wwwcncele.com E-mail: cncele@cncele.com